

*Air-operated setting tools for blind rivets*

**RIVQUICK®**



The new power packages – **RIVQUICK®** T1 to T4.

**[www.boellhoff.com](http://www.boellhoff.com)**

**BOLLHOFF**



## Advantages

- Rationalised model range, with the force to set rivets of increasingly large diameter
- High power-to-weight ratio
- Regulated tool stroke for fast operating cycle
- Rivet setting sequence and capture of the separated mandrel, powered by a single air supply to the tool
- New design of gripping jaw system increases the tool life many times over
- Rivet retention is activated when the tool is gripped
- "Soft-feel" rubberised grip
- Detachable mandrel catcher, with integral protection against ejected mandrels
- Air connection positioned to the rear of the tool, preventing the hose from causing any obstruction
- Holders for replacement nosepieces are built into the base of the tool
- Retractable suspension clip is attached to the head of the tool

### RIVQUICK® T1

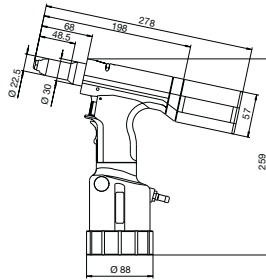

Setting capacity	Blind rivets up to 4 mm Ø aluminium/steel (max. mandrel diameter 2.5 mm)
Setting force	4,200 N at 5 bar
Operating air pressure	5–7 bar
Tool stroke	15 mm
Air consumption	approx. 1.0 l/rivet
Hose connection	6 mm Ø (¼")
Noise level	77 dB
Vibration	< 2.5 m/s <sup>2</sup>
Weight	1.3 kg
Product code	2260 190 1000

### RIVQUICK® T2

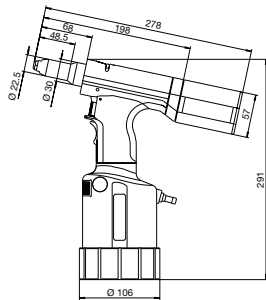

Setting capacity	Blind rivets up to 5 mm Ø, all materials and up to 6 mm aluminium/steel (max. mandrel diameter 3.2 mm)
Setting force	9,000 N at 5 bar
Operating air pressure	5–7 bar
Tool stroke	18 mm
Air consumption	approx. 2.3 l/rivet
Hose connection	6 mm Ø (¼")
Noise level	78 dB
Vibration	< 2.5 m/s <sup>2</sup>
Weight	1.6 kg
Product code	2260 200 1000

### RIVQUICK® T3

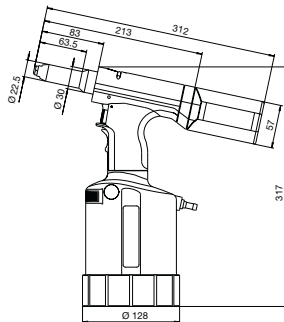

Setting capacity	Blind rivets up to 6.4 mm Ø, all materials (max. mandrel diameter 4.5 mm)
Setting force	14,000 N at 5 bar
Operating air pressure	5–7 bar
Tool stroke	25 mm
Air consumption	approx. 4.8 l/rivet
Hose connection	6 mm Ø (¼")
Noise level	79 dB
Vibration	< 2.5 m/s <sup>2</sup>
Weight	1.9 kg
Product code	2260 210 1000

### RIVQUICK® T4

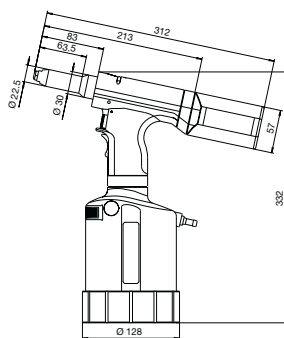

Setting capacity	Blind rivets up to 6.4 mm Ø, all materials and up to 8 mm Ø aluminium (max. mandrel diameter 4.5 mm) suitable for high-strength blind rivets
Setting force	20,000 N at 5 bar
Operating air pressure	5–7 bar
Tool stroke	19 mm
Air consumption	approx. 4.8 l/rivet
Hose connection	6 mm Ø (¼")
Noise level	79 dB
Vibration	< 2.5 m/s <sup>2</sup>
Weight	2.0 kg
Product code	2260 220 1000

Accessories available on request and/or through our internet site.

# BÖLLHOFF

Böllhoff Verbindungstechnik GmbH · Archimedesstraße 1–4 · 33649 Bielefeld · Germany  
Phone +49 (0)5 21 / 44 82-05 (326) · Fax - 6 58 · Internet [www.boellhoff.com](http://www.boellhoff.com) · E-Mail [fasteningtechnology@boellhoff.com](mailto:fasteningtechnology@boellhoff.com)

